

Cylindrical Roller Bearings

Bore Diameter: 17~30mm

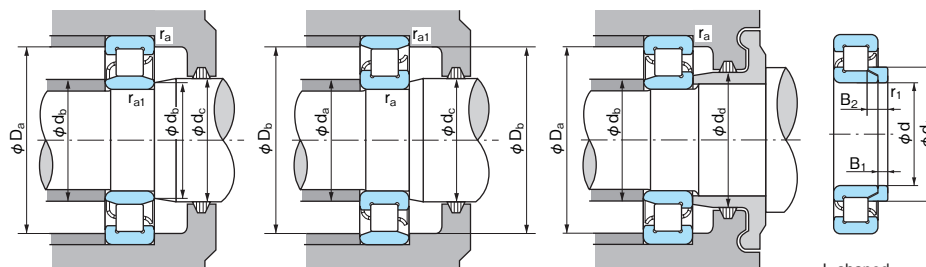
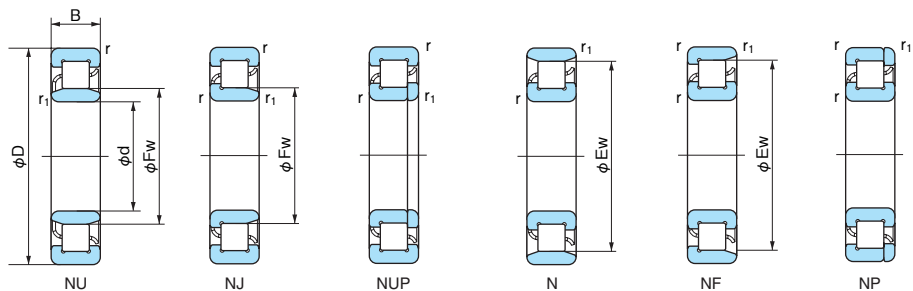

L-shaped thrust collar

1N=0.102kgf

Boundary dimensions (mm)							Bearing No.						Basic dynamic load rating Cr (N)	Basic static load rating Cor (N)	Limiting speed (min ⁻¹)(*)		Abutment and fillet dimensions (mm)								Mass (kg)		Dimensions of L-shaped thrust collar (mm)											
d	D	B	Ew	Fw	r (min)	r1 (min)	NU	NJ	NUP	N	NF	NP	Grease lubrication	Oil lubrication	G	O	da (min)	db (min)	db (max)	dc (min)	dd (min)	Da (max)	Db (max)	Db (min)	ra (max)	ra1 (max)	NU	N	Bearing No.	d	d1 (max)	B1	B2	r1 (min)	Mass (kg) Reference			
17	40	12	33.9	22.9	0.6	0.3	NU 203	NJ	NUP	N	NF	NP					12600	7950	16000	19000	22	19	22	24	25	35	34	34	0.6	0.3	0.082	0.080	—	—	—	—	—	—
20	47	14	40	27	1	0.6	NU 204	NJ	NUP	N	NF	NP	15400	12700	15000	18000	26	25	26	29	32	41	42	42	1	0.6	0.112	0.110	HJ 204	20	30	3	6.75	0.6	0.012			
	47	14	—	26.5	1	0.6	NU 204 E	NJ	NUP	—	—	—	25700	22600	13000	16000	—	25	26	29	32	41	—	—	1	0.6	0.124	—	HJ 204 E	20	29.8	3	5.5	0.6	0.011			
	47	18	—	27	1	0.6	NU 2204	NJ	NUP	—	—	—	20700	18400	14000	17000	—	25	26	29	32	41	—	—	1	0.6	0.144	—	HJ 2204	20	30	3	7.5	0.6	0.012			
	47	18	—	26.5	1	0.6	NU 2204 E	NJ	NUP	—	—	—	30500	28300	13000	16000	—	25	26	29	32	41	—	—	1	0.6	0.162	—	HJ 2204 E	20	29.8	3	6.5	0.6	0.011			
	52	15	44.5	28.5	1.1	0.6	NU 304	NJ	NUP	N	NF	NP	21400	17300	12000	15000	27	25	27	30	33	45	47	47	1	0.6	0.154	0.150	HJ 304	20	31.8	4	7.5	0.6	0.017			
	52	15	—	27.5	1.1	0.6	NU 304 EG	NJ	NUP	—	—	—	31500	26900	12000	15000	—	25	27	30	33	45	—	—	1	0.6	0.150	—	HJ 304 E	20	31.4	4	6.5	0.6	0.016			
	52	21	—	28.5	1.1	0.6	NU 2304	NJ	NUP	—	—	—	30500	27200	11000	14000	—	25	27	30	33	45	—	—	1	0.6	0.213	—	HJ 2304	20	31.8	4	8.5	0.6	0.018			
52	21	—	27.5	1.1	0.6	NU 2304 E	NJ	NUP	—	—	—	42000	39000	11000	14000	—	25	27	30	33	45	—	—	1	0.6	0.240	—	HJ 2304 E	20	31.4	4	7.5	0.6	0.017				
25	47	12	41.5	30.5	0.6	0.3	NU 1005	—	—	N	—	—	14300	13100	15000	18000	29	27.5	30	32	—	42	45	41.8	0.6	0.3	0.086	0.084	—	—	—	—	—	—	—	—		
	52	15	45	32	1	0.6	NU 205	NJ	NUP	N	NF	NP	17700	15700	13000	16000	31	30	31	34	37	46	47	47	1	0.6	0.133	0.130	HJ 205	25	35	3	7.25	0.6	0.015			
	52	15	—	31.5	1	0.6	NU 205 EG	NJ	NUP	—	—	—	29300	27700	12000	14000	—	30	31	34	37	46	—	—	1	0.6	0.140	—	HJ 205 E	25	34.8	3	6	0.6	0.013			
	52	18	—	32	1	0.6	NU 2205	NJ	NUP	—	—	—	24300	23500	12000	14000	—	30	31	34	37	46	—	—	1	0.6	0.163	—	HJ 2205	25	35	3	7.5	0.6	0.016			
	52	18	—	31.5	1	0.6	NU 2205 EG	NJ	NUP	—	—	—	35000	34500	12000	14000	—	30	31	34	37	46	—	—	1	0.6	0.185	—	HJ 2205 E	25	34.8	3	6.5	0.6	0.015			
	62	17	53	35	1.1	1.1	NU 305	NJ	NUP	N	NF	NP	29300	25200	10000	13000	32	32	33	37	40	55	55	55	1	1	0.238	0.230	HJ 305	25	39	4	8	1.1	0.027			
	62	17	—	34	1.1	1.1	NU 305 EG	NJ	NUP	—	—	—	41500	37500	10000	12000	—	32	33	37	40	55	—	—	1	1	0.240	—	HJ 305 E	25	38.2	4	7	1.1	0.024			
	62	24	—	35	1.1	1.1	NU 2305	NJ	NUP	—	—	—	42500	41000	9300	11000	—	32	33	37	40	55	—	—	1	1	0.340	—	HJ 2305	25	39	4	9	1.1	0.029			
	62	24	—	34	1.1	1.1	NU 2305 E	NJ	NUP	—	—	—	57000	56000	9000	11000	—	32	33	37	40	55	—	—	1	1	0.390	—	HJ 2305 E	25	38.2	4	8	1.1	0.026			
80	21	62.8	38.8	1.5	1.5	NU 405	NJ	NUP	N	NF	NP	46500	40000	9000	11000	33.5	33.5	38	41	46	71.5	71.5	64	1.5	1.5	0.564	0.550	HJ 405	25	43.6	6	10.5	1.5	0.054				
30	55	13	48.5	36.5	1	0.6	NU 1006	—	—	N	—	—	19700	19600	12000	15000	35	33.5	35	38	—	49	52	49	1	0.6	0.123	0.121	—	—	—	—	—	—	—			
	62	16	53.5	38.5	1	0.6	NU 206	NJ	NUP	N	NF	NP	23500	21500	11000	13000	36	35	37	40	44	56	57	56	1	0.6	0.204	0.200	HJ 206	30	41.8	4	8.25	0.6	0.026			
	62	16	—	37.5	1	0.6	NU 206 EG	NJ	NUP	—	—	—	39000	37500	9500	12000	—	35	37	40	44	56	—	—	1	0.6	0.210	—	HJ 206 E	30	41.4	4	7	0.6	0.024			
	62	20	—	38.5	1	0.6	NU 2206	NJ	NUP	—	—	—	33000	33000	10000	12000	—	35	37	40	44	56	—	—	1	0.6	0.262	—	HJ 2206	30	41.8	4	8.5	0.6	0.026			
	62	20	—	37.5	1	0.6	NU 2206 EG	NJ	NUP	—	—	—	49000	50000	9500	12000	—	35	37	40	44	56	—	—	1	0.6	0.295	—	HJ 2206 E	30	41.4	4	7.5	0.6	0.025			
	72	19	62	42	1.1	1.1	NU 306	NJ	NUP	N	NF	NP	38500	35000	8500	11000	37	37	40	44	48	65	65	64	1	1	0.357	0.350	HJ 306	30	45.9	5	9.5	1.1	0.044			
	72	19	—	40.5	1.1	1.1	NU 306 EG	NJ	NUP	—	—	—	53000	50000	8500	10000	—	37	40	44	48	65	—	—	1	1	0.370	—	HJ 306 E	30	45.1	5	8.5	1.1	0.041			
	72	27	—	42	1.1	1.1	NU 2306	NJ	NUP	—	—	—	51500	51000	8200	9800	—	37	40	44	48	65	—	—	1	1	0.500	—	HJ 2306	30	45.9	5	11.5	1.1	0.048			
	72	27	—	40.5	1.1	1.1	NU 2306 E	NJ	NUP	—	—	—	74500	77500	8000	9500	—	37	40	44	48	65	—	—	1	1	0.585	—	HJ 2306 E	30	45.1	5	9.5	1.1	0.043			
	90	23	73	45	1.5	1.5	NU 406	NJ	NUP	N	NF	NP	62500	55000	7500	9500	38.5	38.5	44	47	52	81.5	81.5	74	1.5	1.5	0.770	0.750	HJ 406	30	50.5	7	11.5	1.5	0.080			

Note: (*) The dimension table shows limiting speed for bearings made with machined cages. For bearings made with pressed steel cages, multiply the table limits by 0.8.